



GEAR PUMP 3"

AMB 3X136

*Amboretto
Corporation*

GEAR PUMP 3" AMB 3X136



Dimensional Drawing

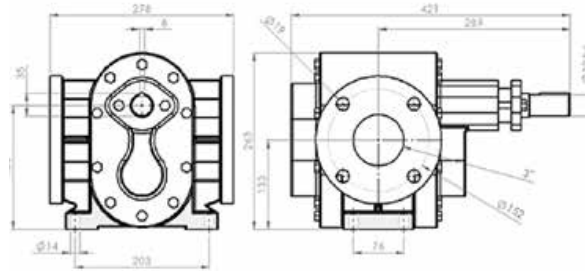

CAPACITY

- Maximum Flow: 52,000 liters/hour
- Maximum Pressure: 15-bar
- Maximum Rotation: 1150-RPM
- Viscosity: From 0,5 up to 200,000 cSt
- Maximum Temperature: Up to 350°C

CHARACTERISTICS

- Flanged suction and retaining nozzles Ø 3"
- (Norm ANSI B16.1 150 lbs);
- Gears helical teeth or spurs;
- Gasket or mechanical seal;
- Sliding bearings in self-lubricating bushings;
- Construction in cast iron, stainless steel, carbon steel or special materials for applications according to customer specification.

APPLICATIONS

- Loading and unloading of tank tractors coupled to the power take-off. Proper for fuel, oils and asphalt carriers;
- Pumping and transfer of fluids in general;
- Lubrication systems;
- Filtration systems;
- Supply units;
- Fluid circulation and recirculation systems;
- Feeding systems for lines, machinery and equipment;
- Dosing in industrial processes;
- Drainage of fluids;
- Systems of refrigeration of machinery and equipment;
- Hydraulics machinery and equipment in general;

OPTIONAL

- Coupling;
- Motor-Pump Set.

FLOW TABLE

RPM, FLOW AND POWER		BOOSTER PRESSURE (KG/CM ²)												
		0	2	4	6	8	10	12	14	16	18	20	22	
1150 RPM	FLOW	liters/hour	52000	51993	51986	51978	51962	51956						
		liters/minute	866.7	866.6	866.4	866.3	866.0	865.9						
		HP	20.00	20.00	25.00	25.00	30.00	30.00						
850 RPM	FLOW	liters/hour	41000	40993	40987	40971	40968	40951	40943					
		liters/minute	683.3	683.2	683.1	682.9	682.8	682.5	682.4					
		HP	20.00	20.00	25.00	25.00	30.00	30.00	30.00					



www.amborettoamericas.com

Amboretto
Corporation