



GEAR PUMP 1.1/2"
ED1.1/2X60B

Amboretto
Corporation

Gear Pump 1.1/2" ED1.1/2X60B



Dimensional Drawing

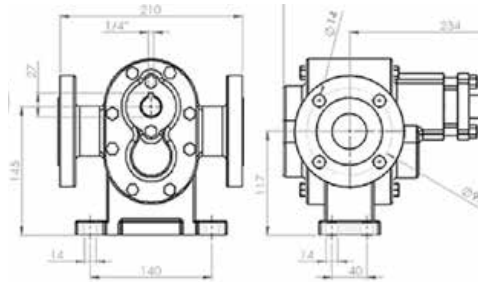

CAPACITY

- Maximum Flow: 13,500 liters/hour
- Maximum Pressure: 15-bar
- Maximum Rotation: 1750-RPM
- Viscosity: From 0,5 up to 200,000 cSt
- Maximum Temperature: Up to 350°C

CHARACTERISTICS

- Flanged suction and retaining nozzles Ø 1.1/2" (Norm ANSI B16.1 150 lbs);
- Gears helical teeth or spurs;
- Gasket or mechanical seal;
- Sliding bearings in self-lubricating bushings;
- Construction in cast iron, stainless steel, carbon steel or special materials for applications according to customer specification.

APPLICATIONS

- Pumping and transfer of fluids in general;
- Lubrication systems;
- Filtration systems;
- Supply units;
- Loading and unloading of tank trucks coupled to the power take-off
- Fluid circulation and recirculation systems;
- Feeding systems for lines, machinery and equipment;
- Dosing in industrial processes;
- Drainage of fluids;
- Systems of refrigeration of machinery and equipment;
- Hydraulics machinery and equipment in general;

OPTIONAL

- Integrated relief valve; Bearing housings;
- Option for threaded suction and retaining nozzles
- Construction in special materials for specific applications Coupling; Motor-Pump Set
- Option for threaded suction and retaining nozzles

FLOW TABLE

RPM, FLOW AND POWER		BOOSTER PRESSURE (KG/CM ²)												
		0	2	4	6	8	10	12	14	16	18	20	22	
1750 RPM	FLOW	liters/hour	13500	13492	13486	13472	13464	13451	13447	13430				
		liters/minute	225.0	224.9	224.8	224.5	224.4	224.2	224.1	223.8				
		HP	5.00	5.00	5.00	7.50	7.50	10.00	10.00	12.50				
1150 RPM	FLOW	liters/hour	8800	8793	8789	8775	8762	8757	8748	8733				
		liters/minute	146.7	146.6	146.5	146.3	146.0	146.0	145.8	145.6				
		HP	5.00	5.00	5.00	7.50	7.50	10.00	10.00	12.50				
850 RPM	FLOW	liters/hour	6508	6941	6489	6473	6467	6454	6442	6431				
		liters/minute	108.5	108.2	108.2	107.9	107.8	107.6	107.4	107.2				
		HP	5.00	5.00	5.00	7.50	7.50	10.00	10.00	12.50				



www.amborettoamericas.com

*Amboretto
Corporation*