



GEAR PUMP 3" CAST IRON

*Amboretto
Corporation*

GEAR PUMP 3" CAST IRON



Dimensional Drawing

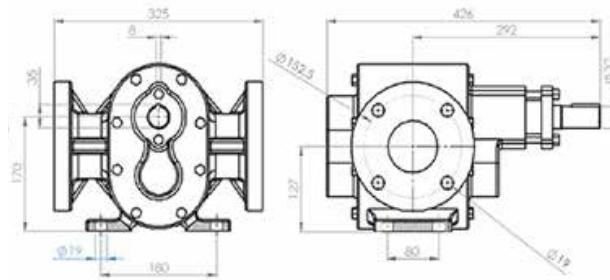

CAPACITY

- Maximum Flow: 30,000 liters/hour
- Maximum Pressure: 15-bar
- Maximum Rotation: 1150-RPM
- Viscosity: From 0,5 up to 200,000 cSt
- Maximum Temperature: Up to 350°C

CHARACTERISTICS

- Flanged suction and retaining nozzles Ø 3"
- (Norm ANSI B16.1 150 lbs);
- Gears helical teeth or spurs;
- Gasket or mechanical seal;
- Sliding bearings in self-lubricating bushings;
- Construction in cast iron, stainless steel, carbon steel or special materials for applications according to customer specification.

APPLICATIONS

- Pumping and transfer of fluids in general;
- Lubrication systems;
- Filtration systems;
- Supply units;
- Loading and unloading of tank trucks coupled to the power take-off
- Fluid circulation and recirculation systems;
- Feeding systems for lines, machinery and equipment;
- Dosing in industrial processes;
- Drainage of fluids;
- Systems of refrigeration of machinery and equipment;
- Hydraulics machinery and equipment in general;

OPTIONAL

- Integrated relief valve; Bearing housings;
- Integrated heating/cooling chamber
- Construction in special materials for specific applications
- Coupling; Motor-Pump Set

FLOW TABLE

RPM, FLOW AND POWER		BOOSTER PRESSURE (KG/CM ²)												
		0	2	4	6	8	10	12	14	16	18	20	22	
1750 RPM	FLOW	liters/hour	30000	29994	29982	29977	29962	29958						
		liters/minute	500.0	499.9	499.7	499.6	499.4	499.3						
		HP	12.50	12.50	15.00	15.00	20.00	20.00						
850 RPM	FLOW	liters/hour	23000	22994	22986	22972	22965	22957	22942					
		liters/minute	383.3	383.2	383.1	382.9	382.8	382.6	382.4					
		HP	12.50	12.50	15.00	15.00	20.00	20.00	25.00					



www.amborettoamericas.com

*Amboretto
Corporation*