



# GEAR PUMP 2" AMB2X86RRL

*Amboretto  
Corporation*

# GEAR PUMP 2" AMB2X86RRL



## Dimensional Drawing

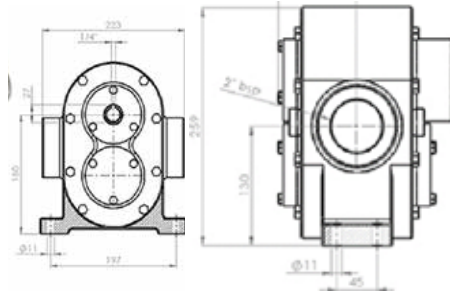

## CAPACITY

- Maximum Flow: 21,000 liters/hour
- Maximum Pressure: 15-bar
- Maximum Rotation: 1150-RPM
- Viscosity: From 0,5 up to 200,000 cSt
- Maximum Temperature: Up to 350°C

## CHARACTERISTICS

- Threaded suction and retaining nozzles Ø 2" BSP;
- Gears helical teeth or spurs;
- Gasket or mechanical seal;
- Sliding bearings in self-lubricating bushings;
- Construction in Cast Iron;

## APPLICATIONS

- Loading and unloading of tank trucks coupled to the power
- take-off. Proper for tank truck of used oil;
- Pumping and transfer of fluids in general;
- Lubrication systems;
- Filtration systems;
- Supply units;
- Fluid circulation and recirculation systems;
- Feeding systems for lines, machinery and equipment;
- Dosing in industrial processes;
- Drainage of fluids;
- Systems of refrigeration of machinery and equipment;
- Hydraulics machinery and equipment in general;

## OPTIONAL

- Bearings in Sintered Bushings Construction in special materials for specific applications Coupling; Motor-Pump Set

## FLOW TABLE

RPM, FLOW AND POWER		BOOSTER PRESSURE (KG/CM <sup>2</sup> )												
		0	2	4	6	8	10	12	14	16	18	20	22	
1750 RPM	FLOW	liters/hour	21000	20993	20986	20972	20965	20951	20948					
		liters/minute	350.0	349.9	349.8	349.5	349.4	349.2	349.1					
		HP	10.00	10.00	10.00	12.50	12.50	15.00	15.00					
1150 RPM	FLOW	liters/hour	18000	17993	17986	17972	17965	17951	17948					
		liters/minute	300.0	299.9	299.8	299.5	299.4	299.2	299.1					
		HP	10.00	10.00	10.00	12.50	12.50	15.00	15.00					



[www.amborettoamericas.com](http://www.amborettoamericas.com)

*Amboretto  
Corporation*